

Package leaflet: Information for the patient

Wegovy® 0.25 mg FlexTouch®

solution for injection in pre-filled pen (semaglutide)

x

x

x

x

x

x

x

x

x

x

x

x

x

x

x

x

x

x

x

x

x

x

x

x

x

x

x

x

x

x

x

x

x

x

x

x

x

x

x

x

x

x

x

x

x

x

x

x

x

x

x

x

x

x

x

x

x

x

x

x

x

x

x

x

x

x

x

x

x

x

x

x

x

x

x

x

x

x

x

x

x

x

x

x

x

x

x

x

x

x

x

x

Children and adolescents

The safety and efficacy of Wegovy in children below 12 years of age have not been studied and are not recommended for use in this population.

x

x

x

x

x

x

x

x

x

x

x

x

x

x

x

x

x

x

x

x

x

x

x

x

x

x

x

x

x

x

x

x

x

x

x

x

x

x

x

x

x

x

x

x

x

x

x

x

x

x

x

x

x

x

x

x

x

x

x

x

x

x

x

x

x

x

x

x

x

x

x

x

x

x

x

x

x

x

x

x

x

x

x

x

x

x

x

x

x

x

x

x

x

x

If you use more Wegovy than you should

Talk to your doctor straight away. You may get side effects such as feeling sick (nausea).

x

x

x

x

x

x

x

x

x

x

x

x

x

x

x

x

x

x

x

x

x

x

x

x

x

x

x

x

x

x

x

x

x

x

x

x

x

x

x

x

x

x

x

x

x

x

x

x

x

x

x

x

x

x

x

x

x

x

x

x

x

x

x

x

x

x

x

x

x

x

x

x

x

x

x

x

x

x

x

x

x

x

x

x

x

x

x

x

x

x

x

x

x

x

5. How to store Wegovy

Keep this medicine out of the sight and reach of children.

x

x

x

x

x

x

x

x

x

x

x

x

x

x

x

x

x

x

x

x

x

x

x

x

x

x

x

x

x

x

x

x

x

x

x

x

x

x

x

x

x

x

x

x

x

x

x

x

x

x

x

x

x

x

x

x

x

x

x

x

x

x

x

x

x

x

x

x

x

x

x

x

x

x

x

x

x

x

x

x

x

x

x

x

x

x

x

x

Instructions on how to use Wegovy® FlexTouch®

Before you begin using your once-weekly Wegovy FlexTouch pen, **always read these instructions carefully**, and talk to your doctor, nurse or pharmacist about how to inject Wegovy correctly.

Wegovy FlexTouch pen is a dial-a-dose pen that **contains four of your prescribed doses of Wegovy, to be used once a week for 4 weeks**. Please use the table inside the lid of the carton to keep track of how many injections you have taken and how many doses remain in your pen.

Wegovy FlexTouch comes in five different strengths, each containing one of the following prescribed doses of semaglutide:

0.25 mg **0.5 mg** **1 mg** **1.7 mg** **2.4 mg**

Always start by checking your pen label to make sure that it contains your prescribed dose of Wegovy.

Your pen is designed to be used with NovoFine Plus, NovoFine or NovoTwist disposable needles up to a length of 8 mm.

1 Prepare your pen with a new needle

Check the name and dose of your pen to make sure it contains your prescribed dose of Wegovy. **Pull off the pen cap.**

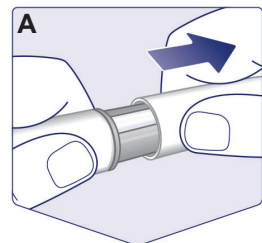

Check that the Wegovy in your pen is clear and colourless. Look through the pen window. If Wegovy looks cloudy or coloured, do not use the pen.

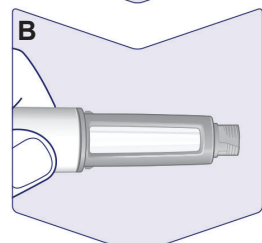

Always use a new needle for each injection.

Take a needle when you are ready to take your injection. Check the paper tab and the outer needle cap for damages. If you see any damage, this could affect sterility. Dispose of it and use a new needle. **Tear off the paper tab.**

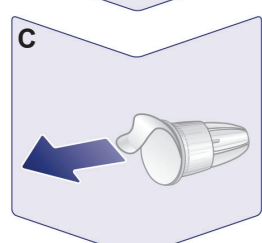

Push the needle straight onto the pen. Turn until it is on tight.

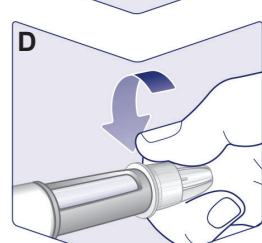

The needle is covered by two caps. You must remove both caps. If you forget to remove both caps you will not inject any Wegovy.

Pull off the outer needle cap and keep it for later. You will need it to safely remove the needle from the pen after the injection.

Pull off the inner needle cap and dispose of it. A drop of Wegovy may appear at the needle tip. You must still check the Wegovy flow if you use a new pen for the first time. See 'Check the flow with each new pen'.

Never use a bent or damaged needle. For more information about needle handling, see 'About your needles' below these instructions.

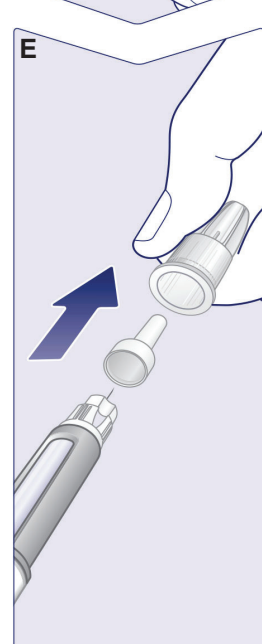

About your needles

Needles are medical devices. **How to identify a blocked or damaged needle**

- If -0- does not appear in the dose counter after continuously pressing the dose button, you may have used a blocked or damaged needle.
- In this case, you have **not** received any Wegovy – even though the dose counter has moved from the original dose that you have set.

How to handle a blocked needle

- Change the needle as instructed in '1 Prepare your pen with a new needle' and go to '2 Set your dose'.

Check the flow with each new pen

Only check the Wegovy flow before your **first injection with each new pen**.

If your Wegovy pen is already in use, go to '2 Set your dose'. Turn the dose selector until you see the flow check symbol (••→).



Make sure the flow check symbol lines up with the dose pointer.

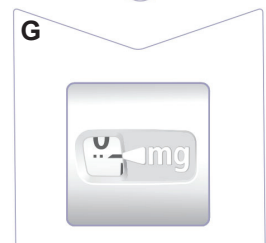

Check the flow

Hold the pen with the needle pointing up. **Press and hold in the dose button** until the dose counter returns to -0-. The -0- must line up with the dose pointer. A drop of Wegovy should appear at the needle tip. This drop indicates that your pen is ready for use.

If a drop does not appear, check the flow again. **This should only be done twice.** If there is still no drop, **change the needle and check the flow once more.** **Do not use the pen** if a drop of Wegovy still does not appear.

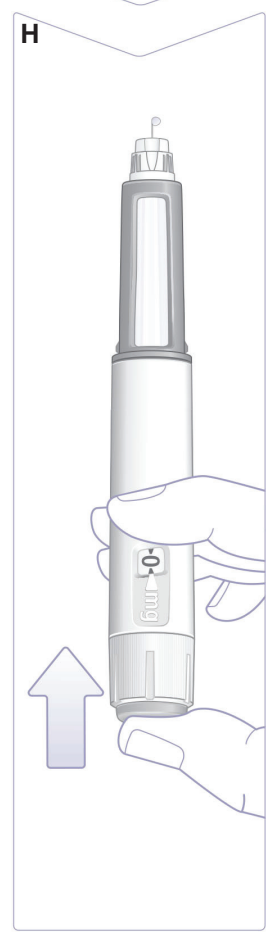

Wegovy® FlexTouch® pen (example)

Please note: Your pen may differ in size from the pen shown in the pictures. These instructions apply to all Wegovy pens.

The pack contains:

- Wegovy FlexTouch pen
- 4 NovoFine Plus needles
- Leaflet

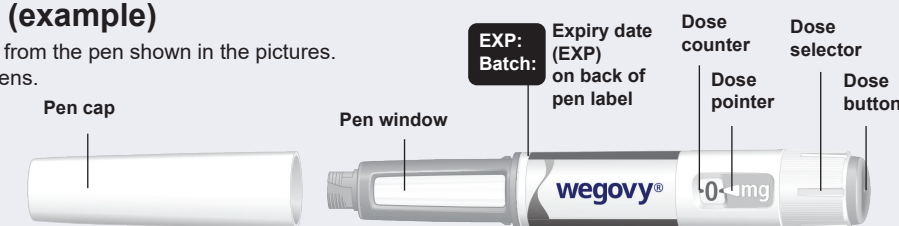

2 Set your dose

Turn the dose selector until the **dose counter stops**, and it **shows your prescribed dose**.



The dashed line (|) in the dose counter will guide you to your dose.

The dose selector clicks differently when turned forward, backwards or past your dose. You will hear a 'click' every time you turn the dose selector. Do not set the dose by counting the number of clicks you hear.



When your prescribed dose lines up with the dose pointer, you have selected your dose. In this picture, the dose **0.25 mg** is shown as an example.

If the dose counter stops before you reach your prescribed dose, see the section 'Do you have enough Wegovy?' below these instructions.



Choose your injection site

Choose upper arms, stomach or upper legs (keep a 5 cm distance from your belly button).

You may inject in the same body area each week, but make sure it is not in the same spot as used the last time.

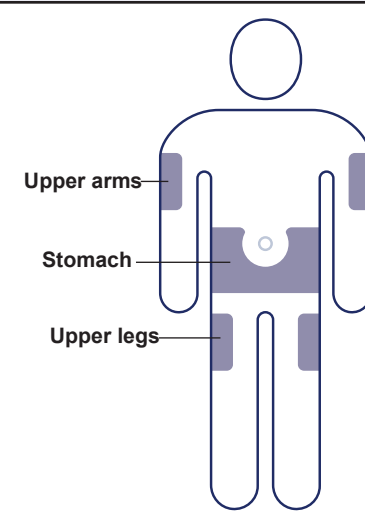

Do you have enough Wegovy?

If the dose counter stops before you reach your prescribed dose, there is not enough Wegovy left for a full dose. Dispose of the pen and use a new Wegovy FlexTouch pen.



3 Inject your dose

Insert the needle into your skin. Make sure you can see the dose counter. Do not cover it with your fingers. This could interrupt the injection.

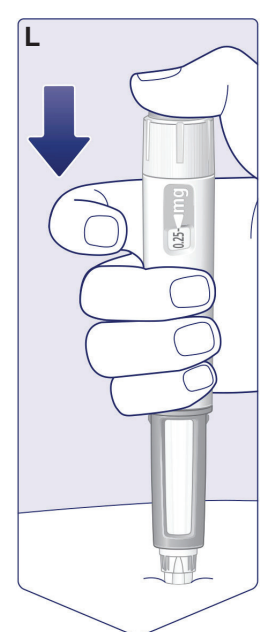

Press and hold down the dose button until the dose counter shows -0-.

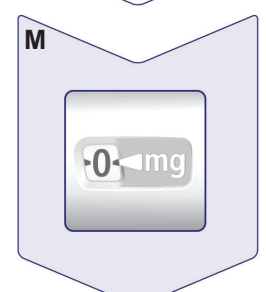

Keep pressing the dose button with the needle in your skin and slowly count to 6. The -0- must line up with the dose pointer. You may hear or feel a click when the dose counter returns to -0-.

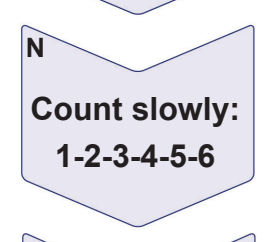

Remove the needle from your skin. If the needle is removed earlier, a stream of Wegovy may come from the needle tip and the full dose will not be delivered. If blood appears at the injection site, press lightly on the area to stop the bleeding. You may see a drop of Wegovy at the needle tip after injecting. This is normal and does not affect your dose.

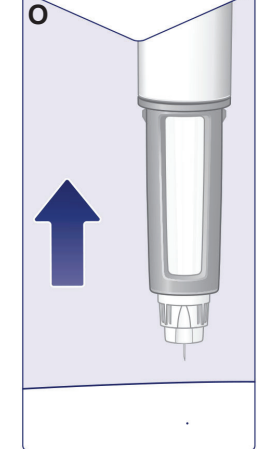

NovoFine® Plus needle (example)

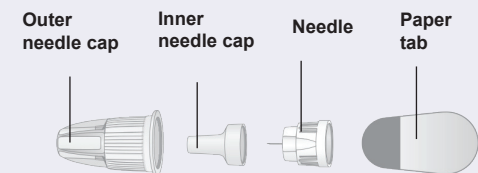

4 After your injection

Lead the needle tip into the outer needle cap on a flat surface without touching the needle or the outer needle cap. **Once the needle is covered**, carefully push the outer needle cap completely on.

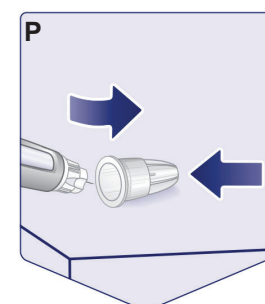

Unscrew the needle and dispose of it carefully as instructed by your doctor, nurse, pharmacist or local authorities. **Never try to put the inner needle cap back on the needle.** You may stick yourself with the needle. **Always dispose of the needle immediately after each injection** to prevent blocked needles, contamination, infection and inaccurate dosing. **Never store your pen with the needle attached.**

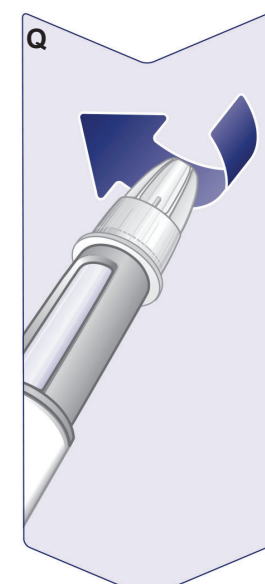

Put the pen cap on your pen after each use to protect Wegovy from light.



When the pen is empty, dispose of the pen without a needle on as instructed by your doctor, nurse, pharmacist or local authorities. The pen cap and the empty carton can be disposed of in your household waste.

⚠ Important information

- **Only inject one dose of Wegovy once weekly.** If you do not take your Wegovy as prescribed, you may not get the intended effect of this medicine.
- If you take more than one type of injectable medicine, it is very **important to check the name and dose** of your pen label **before use.**
- **Do not use this pen without help if you have poor eyesight and cannot follow these instructions.** Get help from a person with good eyesight who is trained to use the Wegovy FlexTouch pen.
- Always keep pen and needles **out of sight and reach of others, especially children.**
- **Never share** your pen or your needles with other people.
- **Needles are for single use only. Never reuse your needles** as it may lead to blocked needles, contamination, infection and inaccurate dosing.
- Caregivers must be **very careful when handling used needles** to prevent accidental needle stick injuries and infection.