

SUMMARY OF PRODUCT CHARACTERISTICS

1 NAME OF THE MEDICINAL PRODUCT

Estraderm MX 100®

2 QUALITATIVE AND QUANTITATIVE COMPOSITION

The active ingredient is *estra-1, 3,5(10)-triene-3,17 β -diol* (oestradiol hemihydrate).

Patches contain 3.0 mg active substance corresponding to a surface area of 44cm².

For a full list of excipients, see section 6.1.

3 PHARMACEUTICAL FORM

Estraderm MX is a square-shaped, self-adhesive, transparent, transdermal patch for application to the skin surface. Each patch comprises an impermeable polyester backing film, an adhesive matrix containing estradiol and an oversized protective liner which is removed prior to application of the patch to the skin. Estraderm MX releases estradiol into the circulation via intact skin at a low rate for up to 4 days.

Cross section:

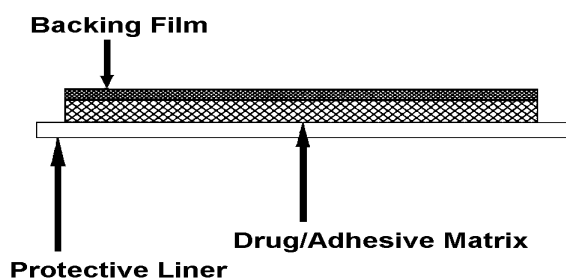

DOSAGE STRENGTHS

ESTRADERM MX 100

Nominal rate of estradiol release	100 micrograms/day
Estradiol content	3.0mg
Drug-releasing area	44 cm ²
Imprint (on backing film)	Product logo CG GTG

4 CLINICAL PARTICULARS

4.1 Therapeutic indications

- Hormone replacement therapy (HRT) for oestrogen deficiency symptoms in postmenopausal women[at least 6 months since last menses].
- Prevention of osteoporosis in postmenopausal women at high risk of future fractures who are intolerant of, or contraindicated for, other medicinal products approved for the prevention of osteoporosis (see section 4.4)

The experience treating women older than 65 years is limited.

4.2 Posology and method of administration

Estraderm MX 100 is an oestrogen only patch.

In women with an intact uterus oestrogen should be supplemented by sequential administration of a progestagen (e.g. medroxyprogesterone acetate 10mg, norethisterone 5mg, norethisterone acetate 1-5mg or dydrogesterone 20mg per day) to be taken at least on the last 12 days of each 4-week treatment cycle. Withdrawal bleeding usually occurs following 12 days or more of progesterone administration. Unless there is a previous diagnosis of endometriosis, it is not recommended to add a progestagen in hysterectomised women.

Dosage

Adults and Elderly

Menopausal symptoms: For initiation and continuation of treatment of postmenopausal symptoms, the lowest effective dose for the shortest duration should be used (see also section 4.4). Depending on the clinical response the dose can then be adjusted to the patient's individual needs. If, after three months, there is insufficient response in the form of alleviated symptoms, the dose can be increased.

A maximum dose of 100 micrograms per day should not be exceeded.

Effects usually of estrogenic origin e.g. breast discomfort, water retention or bloating are often observed at the start of treatment, especially in patients receiving hormone replacement therapy for the first time. However, if symptoms persist for more than six weeks the dose should be reduced.

General instructions: Estraderm MX is administered as a continuous sequential treatment (uninterrupted application twice weekly).

For most postmenopausal women not taking HRT Estraderm MX therapy may be started at any convenient time. However, for women with an intact uterus who are still menstruating regularly, commencement within 5 days of the onset of bleeding is recommended.

In women with an intact uterus transferring from a continuous sequential HRT regimen, treatment should begin the day following completion of the prior regimen.

In women transferring from a continuous-combined HRT regimen, or hysterectomised women transferring from other oestrogen-only HRT treatment, treatment may be started on any convenient day.

Administration: Estraderm MX should be applied immediately after removal of the protective liner (see Figs.), to an area of clean, dry, and intact skin on the trunk below the waistline. The site chosen should be one at which little wrinkling of skin occurs during movement of the body, e.g. buttock. Estraderm MX should never be applied to, or near the breasts.

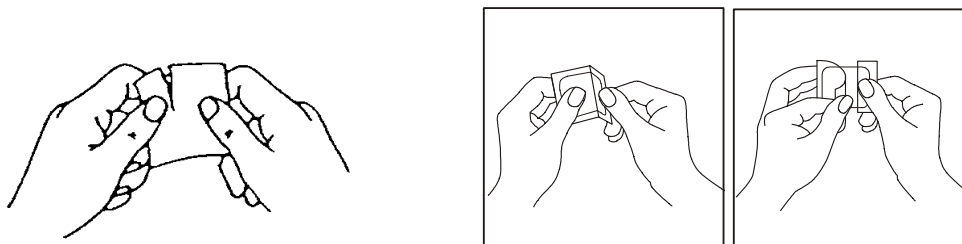

Estraderm MX should be applied twice weekly on a continuous basis, each used patch being removed after 3-4 days and a fresh system applied to a slightly different site.

If a woman has forgotten to apply a patch, she should apply a new patch as soon as possible. The subsequent patch should be applied according to the original treatment schedule. The interruption of treatment might increase the likelihood of recurrence of symptoms and include breakthrough spotting and bleeding.

In the event that a patch should fall off a new patch may be applied. The original treatment schedule should be continued.

The patch should not be exposed to sunlight.

Special populations

Patients with renal and /or hepatic impairment.

No studies were performed in patients with renal and hepatic impairment.

All oestrogen preparations are contraindicated in patients with severe hepatic impairment (see section 4.3 contra-indications).

Children

Estraderm MX is not indicated for use in children.

4.3 Contraindications

Estraderm MX should not be used by women with any of the following conditions:

- Known, past or suspected breast cancer
- Known or suspected oestrogen-dependent malignant tumours (e.g. endometrial cancer)
- Undiagnosed genital bleeding
- Untreated endometrial hyperplasia
- Previous or current venous thromboembolism (deep venous thrombosis, pulmonary embolism)
- Known thrombophilic disorders (e.g. protein C, protein S, or antithrombin deficiency, see section 4.4)
- Active or recent arterial thromboembolic disease (e.g. angina, myocardial infarction)
- Acute liver disease, or a history of liver disease as long as liver function tests have failed to return to normal
- Known hypersensitivity to the active substance or to any of the excipients
- Porphyria

4.4 Special warnings and precautions for use

For the treatment of postmenopausal symptoms, HRT should only be initiated for symptoms that adversely affect quality of life. In all cases, a careful appraisal of the risks and benefits should be undertaken at least annually and HRT should only be continued as long as the benefit outweighs the risk.

Evidence regarding the risks associated with HRT in the treatment of premature menopause is limited. Due to the low level of absolute risk in younger women, however, the balance of benefits and risks for these women may be more favourable than in older women.

Medical Examination / follow-up

Before initiating or reinstating HRT, a complete personal and family medical history should be taken. Physical (including pelvic and breast) examination should be guided by this and by the contraindications and warnings for use. During treatment, periodic check-ups are recommended of a frequency and nature adapted to the individual woman. Women should be advised what changes in their breasts should be reported to their doctor or nurse (see 'Breast cancer' below). Investigations, including appropriate imaging tools e.g. mammography, should be carried out in accordance with currently accepted screening practices, modified to the clinical needs of the individual.

Conditions which need supervision

If any of the following conditions are present, have occurred previously, and/or have been aggravated during pregnancy or previous hormone treatment, the patient should be closely supervised. It should be taken into account that these conditions may recur or be aggravated during treatment with Estraderm MX, in particular:

- Leiomyoma (uterine fibroids) or endometriosis
- Risk factors for thromboembolic disorders (see below)
- Risk factors for oestrogen dependent tumours, e.g. 1st degree heredity for breast cancer
- Hypertension
- Liver disorders (e.g. liver adenoma)
- Diabetes mellitus with or without vascular involvement
- Cholelithiasis
- Migraine or (severe) headache
- Systemic lupus erythematosus
- A history of endometrial hyperplasia (see below)
- Epilepsy
- Asthma
- Otosclerosis

Reasons for immediate withdrawal of therapy

Therapy should be discontinued in case a contraindication is discovered and in the following situations:

- Jaundice or deterioration in liver function
- Significant increase in blood pressure
- New onset of migraine-type headache
- Pregnancy

Endometrial hyperplasia and carcinoma

In women with an intact uterus the risk of endometrial hyperplasia and carcinoma is increased when oestrogens are administered alone for prolonged periods. The reported increase in endometrial cancer risk among oestrogen-only users varies from 2- to 12-fold greater compared with non-users, depending on the duration of treatment and oestrogen dose (see section 4.8). After stopping treatment risk may remain elevated for at least 10 years.

The addition of a progestagen cyclically for at least 12 days per month/28 day cycle or continuous combined oestrogen-progestagen therapy in non-hysterectomised women prevents the excess risk associated with oestrogen-only HRT. Withdrawal bleeding usually occurs following the 12 days or more of progestagen administration.

For oral doses of estradiol >2mg, conjugated equine oestrogens >0.625 mg and patches >50 ug/day the endometrial safety of added progestagens has not been demonstrated.

For Estraderm MX 100 the endometrial safety of added progestogens has not been studied.

Break-through bleeding and spotting may occur during the first months of treatment. If break-through bleeding or spotting appears after some time on therapy, or continues after treatment has been discontinued, the reason should be investigated, which may include endometrial biopsy to exclude endometrial malignancy.

Unopposed oestrogen stimulation may lead to premalignant or malignant transformation in the residual foci of endometriosis. Therefore, the addition of progestagens to oestrogen replacement therapy should be considered in women who have undergone hysterectomy because of endometriosis, if they are known to have residual endometriosis.

Breast cancer

The overall evidence shows an increased risk of breast cancer in women taking combined oestrogen - progestagen or oestrogen-only HRT, that is dependent on the duration of taking HRT.

Combined oestrogen-progestagen therapy

The randomised placebo-controlled trial, the Women's Health Initiative study (WHI), and a meta-analysis of prospective epidemiological studies are consistent in finding an increased risk of breast cancer in women taking combined oestrogen-progestagen for HRT that becomes apparent after about 3 (1-4) years (see section 4.8).

Oestrogen-only therapy

The WHI trial found no increase in the risk of breast cancer in hysterectomised women using oestrogen-only HRT. Observational studies have mostly reported a small increase in risk of having breast cancer diagnosed that is substantially lower than that found in users of oestrogen-progestagen combinations (see section 4.8).

Results from a large meta-analysis showed that after stopping treatment, the excess risk will decrease with time and the time needed to return to baseline depends on the duration of prior HRT use. When HRT was taken for more than 5 years, the risk may persist for 10 years or more.

HRT, especially oestrogen-progestagen combined treatment, increases the density of mammographic images which may adversely affect the radiological detection of breast cancer.

Ovarian cancer

Ovarian cancer is much rarer than breast cancer. Epidemiological evidence from a large meta-analysis suggests a slightly increased risk in women taking oestrogen-only or combined oestrogen-progestagen HRT, which becomes apparent within 5 years of use and diminishes over time after stopping.

Some other studies including the WHI trial suggest that the use of combined HRTs may be associated with a similar, or slightly smaller, risk (see section 4.8).

Venous thromboembolism

HRT is associated with a 1.3-3 fold risk of developing venous thromboembolism (VTE), i.e. deep vein thrombosis or pulmonary embolism.

The occurrence of such an event is more likely in the first year of HRT than later (see section 4.8).

Generally recognised risk factors for VTE include use of oestrogens, older age, major surgery, prolonged immobilisation, obesity (Body Mass Index $>30\text{kg/m}^2$), pregnancy/postpartum period, systemic lupus erythematosus (SLE) and cancer. There is no consensus about the role of varicose veins in VTE.

Patients with known thrombophilic states have an increased risk of VTE and HRT may add to this risk. HRT is therefore contraindicated in these patients (see section 4.3). Women already on chronic anticoagulant treatment require careful consideration of the benefit-risk of use of HRT.

As in all post-operative patients prophylactic measures need to be considered to prevent VTE following surgery. If prolonged immobilisation is to follow elective surgery, temporarily stopping HRT four to six weeks earlier is recommended. Treatment should not be restarted until the woman is completely mobilised.

In women with no personal history of VTE but with a first degree relative with a history of thrombosis at young age, screening may be offered after careful counselling regarding its limitations (only a proportion of thrombophilic defects are identified by screening). If a thrombophilic defect is identified which segregates with thrombosis in family members or if the defect is 'severe' (e.g. antithrombin, protein S, or protein C deficiencies or a combination of defects) HRT is contraindicated.

If VTE develops after initiating therapy, the drug should be discontinued. Patients should be told to contact their doctors immediately when they are aware of a potential thromboembolic symptom (e.g. painful swelling of a leg, sudden pain in the chest, dyspnoea).

Coronary artery disease (CAD)

HRT should not be used to prevent cardiovascular disease.

There is no evidence from randomised controlled trials of protection against myocardial infarction in women with or without existing CAD who received combined oestrogen-progestagen or oestrogen-only HRT.

Combined oestrogen-progestagen therapy

The relative risk of CAD during use of combined oestrogen and progestagen HRT is slightly increased. As the baseline absolute risk of CAD is strongly dependent on age, the number of extra cases of CAD due to oestrogen and progestagen use is very low in healthy women close to menopause, but will rise with more advanced age.

Oestrogen-only

Randomised controlled data found no increased risk of CAD in hysterectomised women using oestrogen-only therapy.

Ischaemic stroke

Combined oestrogen-progestagen and oestrogen-only therapy are associated with an up to 1.5-fold increase in risk of ischaemic stroke. The relative risk does not change with age or time since menopause. However, as the baseline risk of stroke is strongly age-dependent, the overall risk of stroke in women who use HRT will increase with age (see section 4.8).

Severe anaphylactic/anaphylactoid reactions and angioedema

Cases of anaphylactic/anaphylactoid reactions, which developed anytime during the course of Estraderm treatment and required emergency medical management, have been reported in the post marketing setting. Involvement of skin (urticaria, pruritus, swelling of the face, throat, lips, tongue, skin and periorbital oedema) and either respiratory tract (respiratory compromise) or gastrointestinal tract (abdominal pain, vomiting) has been noted. Angioedema requiring medical intervention involving the eye/eyelid, face, larynx, pharynx, tongue and extremities (hands, legs, ankles and fingers) with or without urticaria has occurred in the post marketing experience of using Estraderm. If angioedema involves the tongue, glottis, or larynx, airway obstruction may occur. Patients who develop angioedema after treatment with Estraderm should not receive Estraderm again.

Oestrogens may induce or exacerbate symptoms of angioedema, in particular in women with hereditary angioedema.

Other conditions

Oestrogens may cause fluid retention, and therefore patients with cardiac or renal dysfunction should be carefully observed.

Women with pre-existing hypertriglyceridemia should be monitored closely during oestrogen replacement or hormone replacement therapy, since rare cases of large increases in plasma triglycerides leading to pancreatitis have been reported with oestrogen therapy in this condition.

Exogenous estrogens may induce or exacerbate symptoms of hereditary and acquired angioedema.

Oestrogens increase thyroid binding globulin (TBG), leading to increased circulating total thyroid hormone, as measured by protein-bound iodine (PBI), T4 levels (by column or by radio-immunoassay) or T3 levels (by radio-immunoassay). T3 resin uptake is decreased, reflecting the elevated TBG. Free T4 and free T3 concentrations are unaltered. Other binding proteins may be elevated in serum, i.e. corticoid binding globulin (CBG), sex-hormone-binding globulin (SHBG) leading to increased circulating corticosteroids and sex steroids, respectively. Free or biological active hormone concentrations are unchanged. Other plasma proteins may be increased (angiotensinogen/renin substrate, alpha-I-antitrypsin, ceruloplasmin). These effects may be less common with transdermal oestradiol than with oral oestrogens.

Contact sensitisation is known to occur with all topical applications. Although it is extremely rare, patients who develop contact sensitisation to any of the components of the patch should be warned that a severe hypersensitivity reaction may occur with continuous exposure to the causative agent.

Although observations to date suggest that oestrogens, including transdermal oestradiol, do not impair carbohydrate metabolism, diabetic women should be monitored during initiation of therapy until further information is available.

Thyroid function should be monitored regularly in patients who require thyroid hormone replacement therapy and who are also taking oestrogen in order to ensure that thyroid hormone levels remain within an acceptable range.

Women should be advised that Estraderm MX is not a contraceptive, nor will it restore fertility. Women requiring contraception should be advised to use non hormonal contraception.

HRT use does not improve cognitive function. There is some evidence of increased risk of probable dementia in women who start using continuous combined or oestrogen-only HRT after the age of 65.

ALT (Alanine Aminotransferase) elevations

During clinical trials with patients treated for hepatitis C virus (HCV) infections with the combination regimen ombitasvir/paritaprevir/ritonavir with and without dasabuvir, ALT elevations greater than 5 times the upper limit of normal (ULN) were significantly more frequent in women using ethinylestradiol-containing medicinal products such as Combined Hormonal contraceptives (CHCs). Additionally, also in patients treated with glecaprevir/pibrentasvir, ALT elevations were observed in women using ethinylestradiol containing medications such as CHCs. Women using

medicinal products containing oestrogens other than ethinylestradiol, such as estradiol, had a rate of ALT elevation similar to those not receiving any oestrogens; however, due to the limited number of women taking these other oestrogens, caution is warranted for co-administration with the combination drug regimen ombitasvir/paritaprevir/ritonavir with or without dasabuvir and also the regimen glecaprevir/pibrentasvir (see section 4.5).

4.5 Interaction with other medicinal products and other forms of interaction

The metabolism of oestrogens may be increased by concomitant use of substances known to induce drug-metabolising enzymes, specifically cytochrome P450 enzymes, such as anticonvulsants (e.g. phenobarbital, phenytoin, carbamazepine) and anti-infectives (e.g. rifampicin, rifabutin, nevirapine, efavirenz).

Oestradiol is predominantly metabolized by CYP3A4; concomitant administration of inhibitors of CYP3A4 such as ketoconazole, erythromycin or ritonavir may therefore result in an increase of approximately 50% in oestradiol exposure.

Caution should be used if the women is receiving protease inhibitors (e.g. ritonavir and nelfinavir), which are known as strong inhibitors of cytochrome P450 enzymes, and by contrast exhibit inducing properties when used concomitantly with steroid hormones.

Herbal preparations containing St John's wort (*Hypericum perforatum*) may induce the metabolism of oestrogens and progestagens.

At transdermal HRT administration, the first-pass effect in the liver is avoided and, thus transdermally applied oestrogens HRT may be less affected than oral hormones by enzyme inducers.

Clinically, an increased metabolism of oestrogens and progestagens may lead to decreased effects and changes in the uterine bleeding profile.

Effect of HRT with oestrogens on other medicinal products

Hormone contraceptives containing oestrogens have been shown to significantly decrease plasma concentrations of lamotrigine when co-administered due to induction of lamotrigine glucuronidation. This may reduce seizure control. Although the potential interaction between hormone replacement therapy and lamotrigine has not been studied, it is expected that a similar interaction exists, which may lead to a reduction in seizure control among women taking both medicinal products together.

Pharmacodynamic interactions

During clinical trials with the HCV combination drug regimen ombitasvir/paritaprevir/ritonavir with and without dasabuvir, ALT elevations greater than 5 times the upper limit of normal (ULN) were significantly more frequent in women using ethinylestradiol-containing medicinal products such as CHCs. Women using medicinal products containing oestrogens other than ethinylestradiol, such as estradiol, had a rate of ALT elevation similar to those not receiving any oestrogens; however, due to the limited number of women taking these other oestrogens, caution is warranted for co-administration with the combination drug regimen ombitasvir/paritaprevir/ritonavir with or without dasabuvir and also the regimen with glecaprevir/pibrentasvir (see section 4.4).

Some laboratory tests may be influenced by oestrogen therapy, such as tests for glucose tolerance or thyroid function.

4.6 Fertility, Pregnancy and lactation

Pregnancy

Estraderm MX is not indicated during pregnancy. If pregnancy occurs during medication with Estraderm MX treatment should be withdrawn immediately.

The results of most epidemiological studies to date relevant to inadvertent foetal exposure to oestrogens indicate no teratogenic or foetotoxic effects.

Lactation

Estraderm MX is not indicated during lactation.

4.7 Effects on ability to drive and use machines

None known.

4.8 Undesirable effects

Adverse drug reactions from multiple sources including clinical trials and post-marketing experience (Table 1) are listed according to the system organ class in MedDRA. Within each system organ class, the adverse drug reactions are ranked by frequency, the most frequent first. Within each frequency grouping, adverse drug reactions are presented in the order of decreasing seriousness. In addition the corresponding frequency using the following convention (CIOMS III) is also provided for each adverse drug reaction: very common ($\geq 1/10$); common ($\geq 1/100$, $< 1/10$); uncommon ($\geq 1/1,000$, $< 1/100$); rare ($\geq 1/10,000$, $< 1/1,000$); very rare ($< 1/10,000$), and not known (cannot be estimated from the available data).

Table 1

Neoplasms benign, malignant and unspecified (including cysts and polyps)	
Uncommon:	Breast cancer.
Immune system disorders	
Very rare:	Anaphylactoid reaction.
Not known*:	Hypersensitivity (incl. anaphylactic reaction and angioedema).
Psychiatric disorders	
Not known*:	Depression, nervousness, affect lability, libido disorder.
Nervous system disorders	
Common:	Headache.
Rare:	Dizziness.
Not known*:	Migraine.
Vascular disorders	
Very rare:	Embolism, hypertension, varicose veins (including exacerbation).
Gastrointestinal disorders	
Common:	Nausea, abdominal pain, abdominal distension.

Not known*:	Vomiting, diarrhoea.
Hepatobiliary disorders	
Very rare:	Liver function tests abnormal, jaundice cholestatic.
Not known*:	Cholelithiasis, gallbladder disorder.
Skin and subcutaneous tissue disorders	
Very rare:	Contact dermatitis, pigmentation disorders, generalised pruritus, generalised exanthema.
Not known*:	Alopecia, chloasma, urticaria.
Musculoskeletal and connective tissue disorders	
Rare:	Pain in extremity (leg pain).
Not known*:	Back pain.
Reproductive system and breast disorders	
Very common:	Breast discomfort, breakthrough bleeding.
Not known*:	Endometrial hyperplasia, uterine leiomyoma, breast pain, breast tenderness, dysmenorrhoea, fibrocystic breast disease, breast enlargement, breast discharge.
General disorders and administration site conditions	
Very common:	Application site reactions**.
Rare:	Oedema, weight increased or decreased.

(*) Reported in post-marketing experience.

(**) Application site reactions includes localised bleeding, bruising, burning, discomfort, dryness, eczema, oedema, erythema, inflammation, irritation, pain, papules, paraesthesia, pruritus, rash, skin discolouration, skin pigmentation, swelling, urticaria, and vesicles.

Breast cancer risk

- An up to 2-fold increased risk of having breast cancer diagnosed is reported in women taking combined oestrogen-progestagen therapy for more than 5 years.
- The increased risk in users of oestrogen-only therapy is lower than that seen in users of oestrogen-progestagen combinations.
- The level of risk is dependent on the duration of use (see section 4.4).
- Absolute risk estimations based on results of the largest randomised placebo-controlled trial (WHI-study) and the largest meta-analysis of prospective epidemiological studies are presented.

Largest meta-analysis of prospective epidemiological studies - Estimated additional risk of breast cancer after 5 years' use in women with BMI 27 (kg/m²)

Age at start HRT (years)	Incidence per 1000 never-users of HRT over a 5 year period (50-54 years)*	Risk ratio	Additional cases per 1000 HRT users after 5 years
Oestrogen only HRT			
50	13.3	1.2	2.7
Combined oestrogen-progestagen			
50	13.3	1.6	8.0
<p>Note: Since the background incidence of breast cancer differs by EU country, the number of additional cases of breast cancer will also change proportionately. * Taken from baseline incidence rates in England in 2015 in women with BMI 27 (kg/m²).</p>			

Estimated additional risk of breast cancer after 10 years' use in women with BMI 27 (kg/m²)

Age at start HRT (years)	Incidence per 1000 never-users of HRT over a 10 year period (50- 59 years) *	Risk ratio	Additional cases per 1000 HRT users after 10 years
Oestrogen only HRT			
50	26.6	1.3	7.1
Combined oestrogen-progestagen			
50	26.6	1.8	20.8
*Taken from baseline incidence rates in England in 2015 in women with BMI 27 (kg/m ²)			
Note: Since the background incidence of breast cancer differs by EU country, the number of additional cases of breast cancer will also change proportionately.			

US WHI studies - additional risk of breast cancer after 5 years' use

Age range (years)	Incidence per 1000 women in placebo arm over 5 years	Risk ratio & 95%CI	Additional cases per 1000 HRT users over 5 years (95% CI)
CEE oestrogen-only			
50-79	21	0.8 (0.7 - 1.0)	-4 (-6 - 0)*
CEE+MPA oestrogen & progestagen‡			
50-79	17	1.2 (1.0 - 1.5)	+4 (0 - 9)

‡When the analysis was restricted to women who had not used HRT prior to the study there was no increased risk apparent during the first 5 years of treatment: after 5 years the risk was higher than in non-users.

* WHI study in women with no uterus, which did not show an increase in risk of breast cancer.

Endometrial cancer risk

Postmenopausal women with a uterus

The endometrial cancer risk is about 5 in every 1000 women with a uterus not using HRT.

In women with a uterus, use of oestrogen-only HRT is not recommended because it increases the risk of endometrial cancer (see section 4.4).

Depending on the duration of oestrogen-only use and oestrogen dose, the increase in risk of endometrial cancer in epidemiology studies varied from between 5 and 55 extra cases diagnosed in every 1000 women between the ages of 50 and 65.

Adding a progestagen to oestrogen-only therapy for at least 12 days per cycle can prevent this increased risk. In the Million Women Study the use of five years of combined (sequential or continuous) HRT did not increase risk of endometrial cancer (RR of 1.0 (0.8-1.2)).

Ovarian cancer

Use of oestrogen-only or combined oestrogen-progestagen HRT has been associated with a slightly increased risk of having ovarian cancer diagnosed (see section 4.4).

A meta-analysis from 52 epidemiological studies reported an increased risk of ovarian cancer in women currently using HRT compared to women who have never used HRT (RR 1.43, 95% CI 1.31-1.56). For women aged 50 to 54 years taking 5 years of HRT, this results in about 1 extra case per 2000 users. In women aged 50 to 54 who are not taking HRT, about 2 women in 2000 will be diagnosed with ovarian cancer over a 5-year period.

Risk of venous thromboembolism

HRT is associated with a 1.3-3-fold increased relative risk of developing venous thromboembolism (VTE), i.e. deep vein thrombosis or pulmonary embolism. The occurrence of such an event is more likely in the first year of using HT (see section 4.4). Results of the WHI studies are presented:

WHI Studies - Additional risk of VTE over 5 years' use

Age range (years)	Incidence per 1000 women in placebo arm over 5 years	Risk ratio and 95%CI	Additional cases per 1000 HRT users
Oral oestrogen-only*			
50-59	7	1.2 (0.6 - 2.4)	1 (-3 - 10)
Oral combined oestrogen-progestagen			
50-59	4	2.3 (1.2 - 4.3)	5 (1 - 13)

* Study in women with no uterus.

Risk of coronary artery disease

- The risk of coronary artery disease is slightly increased in users of combined oestrogen-progestagen HRT over the age of 60 (see section 4.4).

Risk of ischaemic stroke

- The use of oestrogen-only and oestrogen and progestagen therapy is associated with an up to 1.5 fold increased relative risk of ischaemic stroke. The risk of haemorrhagic stroke is not increased during use of HRT.
- This relative risk is not dependent on age or on duration of use, but as the baseline risk is strongly age-dependent, the overall risk of stroke in women who use HRT will increase with age, see section 4.4.

WHI studies combined - Additional risk of ischaemic stroke* over 5 years' use

Age range (years)	Incidence per 1000 women in placebo arm over 5 years	Risk ratio and 95%CI	Additional cases per 1000 HRT users over 5 years
50-59	8	1.3 (1.1 - 1.6)	3 (1 - 5)

* No differentiation was made between ischaemic and haemorrhagic stroke

The following other adverse reactions have been reported in association with oestrogen alone and oestrogen-progestagen treatments:

- Cerebrovascular accident
- Skin and subcutaneous disorders: chloasma, erythema multiforme, erythema nodosum, vascular purpura
- Gall bladder disease
- Probable dementia over the age of 65 (see section 4.4)
- Dry eyes
- Tear film composition changes

4.9 Overdose

This is not likely due to the mode of administration.

Signs and Symptoms: Signs of acute oestrogen overdosage may be either one of, or a combination of, breast discomfort, fluid retention and bloating or nausea.

Treatment: Overdosage can if necessary be reversed by removal of the patch(es).

5 PHARMACOLOGICAL PROPERTIES

5.1 Pharmacodynamic properties

Pharmacotherapeutic group: oestrogens ATC code G 03 C A 03.

The active ingredient, synthetic 17 β -estradiol is chemically and biologically identical to endogenous human estradiol. It substitutes for the loss of oestrogen production in menopausal women, and alleviates menopausal symptoms.

Oestrogens prevent bone loss following menopause or ovariectomy. Oestrogen deficiency at menopause is associated with an increasing bone turnover and decline in bone mass. The effect of estrogens on the bone mineral density is dose-dependent.

Estraderm MX 100 is not recommended as the risk/benefit of the higher dose in osteoporosis has not been assessed in clinical studies. However, it may be used if necessary to control concurrent menopausal symptoms.

Protection appears to be effective for as long as treatment is continued. After discontinuation of HRT, bone mass is lost at a rate similar to that in untreated women.

Evidence from the WHI trial and meta-analysed trials shows that current use of HRT, alone or in combination with a progestin – given to predominantly healthy women – reduces the risk of hip, vertebral, and other osteoporotic fractures. HRT may also prevent fractures in women with low bone density and/or established osteoporosis, but the evidence for that is limited.

5.2 Pharmacokinetic properties

Absorption

Steady-state serum oestradiol concentrations are reached within 8 hours after application of Estraderm MX 50 to the skin, and remain stable during 4 days. The mean E2 concentration during steady-state of Estraderm MX 50 is 41 pg/mL in healthy postmenopausal women, corresponding to a mean increase of 37 pg/mL over the mean baseline value of 4 pg/mL (range 2.1 to 9.0 pg/mL). The E2:E1 ratio

increases from a postmenopausal value of 0.3 to a value of 1.3, similar to the physiological ratio of E2 to E1 observed before the menopause in women with normally functioning ovaries. During continuous treatment of postmenopausal women with Estraderm MX 50 twice weekly for 12 weeks, mean E2 plasma concentrations rise by 36 pg/mL above baseline at the end of the treatment phase, without any indication that accumulation of E2 levels occurs .

With Estraderm MX 25, E2 plasma levels half those observed with Estraderm MX 50 are measured, and with Estraderm MX 100 plasma E2 levels are slightly more than double those measured with Estraderm MX 50 .

Plasma oestradiol concentrations return to baseline value within 24 hours after removal of the patch.

Distribution

In plasma, oestradiol is largely bound to sex hormone binding globulin (SHBG) and albumin. Only a fraction is free and biologically active.

Metabolism

Transdermally applied oestradiol is metabolised in the same way as the endogenous hormone. Oestradiol is metabolised to oestrone, then later – primarily in the liver – to oestriol, epioestriol and catechol oestrogens, which are then conjugated to sulphates and glucuronides. Cytochrome 450 isoforms CYP1A2 and CYP3A4 catalyse the hydroxylation of oestradiol forming oestriol. Oestriol is glucuronidated by UGT1A1 and UGT2B7 in humans. Metabolic plasma clearance ranges from 650 to 900 L/(day x m²). Oestradiol metabolites are also subject to enterohepatic circulation. Oestradiol metabolites are far less active than oestradiol.

Elimination

Oestradiol and its metabolites are mainly excreted in the urine. The plasma elimination half-life of oestradiol is about 1 hour. Oestradiol conjugates excreted in the urine return to pre-application levels on the second or third day after removal of the system.

5.3 Preclinical safety data

Animal studies with estradiol have only shown effects which can be expected from an estrogenic substance.

Acute toxicity of oestrogens is low. Because of marked differences between animal species and between animals and humans, preclinical results possess a limited predictive value for the application of oestrogens in humans.

In experimental animals oestradiol displayed an embryo-lethal effect at relatively low doses; malformations of the urogenital tract and feminisation of male foetuses were observed.

Long-term, continuous administration of natural and synthetic oestrogens in certain animal species increases the frequency of carcinomas of the mammary gland, uterus, cervix, vagina, testis, and liver.

6 PHARMACEUTICAL PARTICULARS

6.1 List of excipients

Acrylate, methacrylate, isopropyl palmitate, polyethylene terephthalate, ethylenevinylacetate copolymer, silicone-coating (on the inner side of the protective release liner which is removed before patch application).

6.2 Incompatibilities

None known

6.3 Shelf life

2 years.

6.4 Special precautions for storage

Store below 25°C.

Keep out of the reach of children both before and after use.

6.5 Nature and contents of container

Each system is individually heat sealed in a paper/aluminium/polyethylene foil pouch. Eight or twenty four Estraderm MX pouches are placed in an appropriately sized carton which comprises the finished product (one or three month's treatment respectively).

6.6 Special precautions for disposal

See Section 4.2. Exposure of Estraderm MX patches to ultra-violet light results in degradation of oestradiol. Patches should not be exposed to sunlight. They should be applied immediately after removal from the pouch to skin sites covered by clothing.

After use, the Estraderm MX patch should be folded (adhesive surfaces pressed together) and discarded in such a way as to keep them out of the reach and sight of children.

7 MARKETING AUTHORISATION HOLDER

Norgine Pharmaceuticals Limited,
ARC Uxbridge, Building 01,
Sanderson Road,
Uxbridge,
UB8 1DH, UK

8 MARKETING AUTHORISATION NUMBER(S)

PL 20011/0067

**9 DATE OF FIRST AUTHORISATION/RENEWAL OF THE
AUTHORISATION**

27/09/1995 / 10/02/2009

10 DATE OF REVISION OF THE TEXT

23/04/2025