

Package leaflet: Information for the user

Rotigotine Luye 1 mg/24 h transdermal patch

Rotigotine Luye 3 mg/24 h transdermal patch

Rotigotine

Read all of this leaflet carefully before you start using this medicine because it contains important information for you.

- Keep this leaflet. You may need to read it again.
- If you have any further questions, ask your doctor or pharmacist.
- This medicine has been prescribed for you only. Do not pass it on to others. It may harm them, even if their signs of illness are the same as yours.
- If you get any side effects, talk to your doctor or pharmacist. This includes any possible side effects not listed in this leaflet. See section 4.

What is in this leaflet

1. What Rotigotine Luye is and what it is used for
2. What you need to know before you use Rotigotine Luye
3. How to use Rotigotine Luye
4. Possible side effects
5. How to store Rotigotine Luye
6. Contents of the pack and other information

1. What Rotigotine Luye is and what it is used for

What Rotigotine Luye is

Rotigotine Luye contains the active substance rotigotine.

It belongs to a group of medicines called 'dopamine agonists'. Dopamine is a messenger in the brain which is important for movement.

What Rotigotine Luye is used for

Rotigotine Luye is used in adults to treat the signs and symptoms of:

- **Restless Legs Syndrome (RLS)** – this can be associated with discomfort in your legs or arms, urges to move around, sleep disturbance and feeling tired or sleepy during the day. These symptoms are either reduced or their duration is shortened with Rotigotine Luye treatment.

2. What you need to know before you use Rotigotine Luye

Do not use Rotigotine Luye if:

- you are **allergic to rotigotine** or any of the **other ingredients** of this medicine (listed in section 6)
- you need to have a **magnetic resonance imaging (MRI)** scan (diagnostic pictures of the inside of the body, created using magnetic rather than x-ray energy)
- you need '**cardioversion**' (specific treatment for abnormal heart beat).

You must take your Rotigotine Luye patch off just before undergoing magnetic resonance imaging (MRI) or cardioversion to avoid skin burns because the patch contains aluminium. You can put a new patch on afterwards.

If any of the above apply to you, do not use Rotigotine Luye. If you are not sure about this, talk to your doctor or pharmacist first.

Warnings and precautions

Talk to your doctor or pharmacist before using Rotigotine Luye. This is because:

- your **blood pressure** needs checking regularly while using Rotigotine Luye, especially at the start of the treatment. Rotigotine Luye may affect your blood pressure.
- your eyes need checking regularly while using Rotigotine Luye. If you notice any problems with your eyesight between checks, talk to your doctor straight away.
- if you have serious **liver problems**, your doctor may need to change the dose. If your liver problems get worse during treatment, talk to your doctor straight away.
- you may get **skin problems** caused by the patch – see '**Skin problems caused by the patch**' in section 4.
- you may **feel very sleepy** or **fall asleep suddenly** – see '**Driving and using machines**' in section 2.
- your symptoms of **Restless Legs Syndrome** may start earlier than usual, be more intense and involve other limbs. If you experience such symptoms either before or after beginning treatment with Rotigotine Luye, contact your doctor as your treatment may need to be adjusted.

Medicines used to treat Restless Legs Syndrome should be reduced or stopped gradually. Tell your doctor if after stopping or reducing your Rotigotine Luye treatment you experience symptoms such as depression, anxiety, fatigue, sweating or pain.

Loss of consciousness can occur

Rotigotine Luye can cause loss of consciousness. This can happen especially when you start using Rotigotine Luye or when your dose is increased. Tell your doctor if you lose consciousness or feel dizzy.

Changes in behaviour and abnormal thinking

Rotigotine Luye can cause side effects that change your behaviour (how you act). You may find it helpful to tell a member of your family or carer that you are using this medicine and ask them to read this leaflet. This is so that your family or carer can tell you, or your doctor, if they are worried about any changes in your behaviour. Tell your doctor if you or your family/carer notices you are using the drug excessively or developing craving for large doses of Rotigotine Luye or other medicines used to treat Restless Legs Syndrome.

See '**Changes to your behaviour and abnormal thinking**' in section 4 for more information.

Children and adolescents

Do **not** give this medicine to **children** below 18 years of age because it is not known if it is safe or effective in this age group.

Other medicines and Rotigotine Luye

Tell your doctor or pharmacist if you are taking, have recently taken or might take any other medicines. This includes medicines obtained without a prescription and herbal medicines.

Do not take the following medicines while using Rotigotine Luye – because they may decrease its effect:

- 'anti-psychotic' medicines – used to treat certain mental illnesses
- metoclopramide – used to treat nausea (feeling sick) and vomiting

Talk to your doctor before using Rotigotine Luye if you are taking:

- sedating medicines such as benzodiazepines or medicines used to treat mental illness or depression
- medicines that lower blood pressure. Rotigotine Luye may decrease blood pressure when you stand up – this effect may be worsened by the medicines used to lower blood pressure

Your doctor will let you know if it is safe to keep taking these medicines while using Rotigotine Luye.

Rotigotine Luye with food, drink and alcohol

Because rotigotine enters your bloodstream through your skin, food or drink does not affect the way this medicine is absorbed by the body. You should discuss with your doctor if it is safe for you to drink alcohol while using Rotigotine Luye.

Pregnancy and breast-feeding

Do not use Rotigotine Luye if you are pregnant. This is because the effects of rotigotine on pregnancy and the unborn baby are not known.

Do not breast-feed during treatment with Rotigotine Luye. This is because rotigotine may pass into your breast milk and affect your baby. It is also likely to lower the amount of milk you produce.

If you are pregnant or breast-feeding, think you may be pregnant or are planning to have a baby, ask your doctor or pharmacist for advice before using this medicine.

Driving and using machines

Rotigotine Luye may make you feel very sleepy and you may fall asleep very suddenly. If this happens, do not drive. In isolated cases, people have fallen asleep while driving and this has caused accidents.

Also do not use tools or machines if you feel very sleepy – or do anything else which may put others or yourself at risk of serious injury.

3. How to use Rotigotine Luye

Always use this medicine exactly as your doctor or pharmacist has told you. Check with your doctor or pharmacist if you are not sure.

Which strength patches to use

Rotigotine Luye is available in different strength patches which release the medicine over 24 hours. The strengths are 1 mg/24 h, 2 mg/24 h and 3 mg/24 h for the treatment of Restless Leg Syndrome.

- Your starting dose will be one 1 mg/24 h patch each day.
- From the second week, your daily dose may be increased by 1 mg each week – until you get to the right maintenance dose for you. This is when you and your doctor agree that the symptoms are being controlled well enough and the side effects of the medicines are acceptable.
- Please follow the instructions of the prescriber carefully.
- The maximum dose is 3 mg per day.

If you have to stop taking this medicine, see '**If you stop using Rotigotine Luye**' in section 3.

How to use the Rotigotine Luye patches:

Rotigotine Luye is a patch that is put on the skin.

- Make sure that you take the old patch off before putting on a new one.
- Stick the new patch on a **different area of the skin each day**.
- Leave the patch on your skin for 24 hours, then take it off and put on a new one.
- **Change the patches** at about the **same time every day**.
- **Do not cut the patches into pieces**.

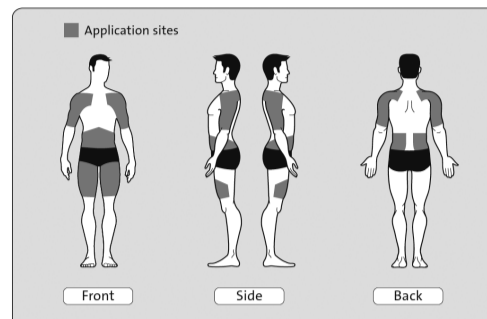

Where to stick the patch

Put the sticky side of the patch onto clean, dry, healthy skin on the following areas as shown in grey on the pictures opposite:

- Shoulder or upper arm
- Belly
- Flank (your side, between the ribs and hips)
- Thigh or hip

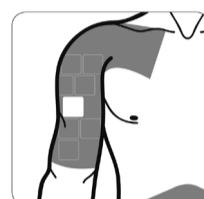

To avoid skin irritation

- Stick the patch onto a **different area of skin each day**. For example, put it on the right side of your body one day, then on the left side of your body the next day. Or on your upper body one day, then on your lower body the day after that.
- Do **not** stick the patch on the **same area of skin twice within 14 days**.
- Do **not** stick the patch on **broken or damaged skin** – or on skin that is **red or irritated**.

If you still get problems with your skin because of the patch, please see '**Skin problems caused by the patch**' in section 4 for more information.

To prevent the patch becoming loose or falling off

- Do **not** put the patch in an area where it can be **rubbed by tight clothing**.
- Do **not** use **creams, oils, lotions, powders** or other **skin products** where you will put the patch. Also do not use them on or near a patch you are already wearing.
- If you need to stick the patch to a hairy area of skin, you must **shave** the area at least **3 days before** sticking the patch there.
- If the edges of the patch lift, the patch may be taped down with adhesive medical tape.

If the patch falls off, put on a new patch for the rest of the day – then replace the patch at the usual time.

- Do **not** let the area of the patch **get hot** – for example too much sunlight, saunas, hot baths, heating pads or hot-water bottles. This is because the medicine may be released faster. If you think that too much heat has been applied, contact your doctor or pharmacist.
- Always check that the patch has not fallen off after activities such as bathing, showering or exercising.
- If the patch has **irritated your skin**, **keep** that area **protected from direct sunlight**. This is because it may change the colour of the skin.

How to use the patch

- Each patch is packed in a separate sachet.
- Before opening the sachet decide where you are going to stick this new patch and check you have removed any old patch.
- Stick the Rotigotine Luye patch onto your skin as soon as you have opened the sachet, removed the cover sheet and the release liner.

1. To open the sachet, hold the sachet in both hands.

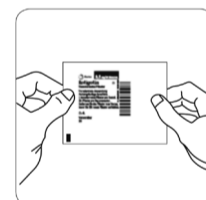

2. Peel apart the foil

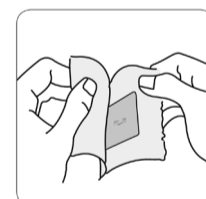

3. Open the sachet.

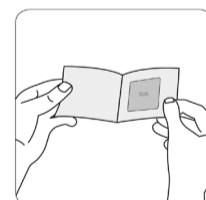

4. Take the patch out of the sachet. Remove the cover sheet from the top, tan-coloured side of the patch and discard it. A protective transparent liner (release liner) covers the sticky side of the patch.

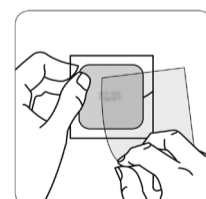

5. Hold the patch in both hands with the transparent release liner facing you. Peel off one side of the release liner and do not touch the sticky part of the patch with the fingers.

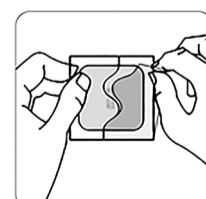

6. Put the sticky side of the patch on the skin and then peel off the second side of the release liner.

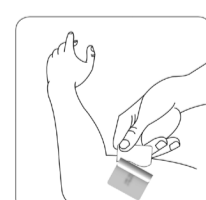

7. Press the patch down firmly with the palm of your hand. Keep it pressed for about 30 seconds. This makes sure the patch is touching the skin and the edges stick down well. Wash your hands with soap and water straight after handling the patch.



How to take off a used patch

- Slowly and carefully peel off the used patch.
- Gently wash the area with warm water and mild soap. This will remove any stickiness that stays on your skin. You can also use a little baby oil to remove any stickiness that will not wash off.
- Do not use alcohol or other dissolving liquids – such as nail polish remover. These may irritate your skin.

If you use more Rotigotine Luye than you should

Using higher doses of Rotigotine Luye than your doctor has prescribed may cause side effects such as feeling sick (nausea) or vomiting, low blood pressure, seeing or hearing things that are not real (hallucinations), feeling confused, very sleepy, having involuntary movements and convulsions.

In such cases, contact your doctor or hospital straight away. They will tell you what to do.

If you forget to change the patch at your usual time

- If you have forgotten to change the patch at your usual time, change it as soon as you remember. Take off the old patch and use a new one.
- If you have forgotten to stick on a new patch after removing the old one, use a new patch as soon as you remember.

In both cases, use a new patch at the usual time on the following day. Do not use a double dose to make up for a forgotten dose.

If you stop using Rotigotine Luye

Do not stop using Rotigotine Luye without talking to your doctor. A sudden stop could lead to a medical condition called 'neuroleptic malignant syndrome' which could be life-threatening. The signs include: loss of muscle movement (akinesia), rigid muscles, fever, unstable blood pressure, increased heart rate (tachycardia), confusion, low level of consciousness (such as a coma).

If your doctor says you should stop Rotigotine Luye, the daily dose should be lowered gradually:

- **Restless Legs Syndrome** – lowered by 1 mg every other day.

If you have any further questions on the use of this medicine, ask your doctor or pharmacist.

4. Possible side effects

Like all medicines, this medicine can cause side effects, although not everybody gets them. Tell your doctor, pharmacist or nurse if you notice any side effects.

Side effects more likely at the start of treatment

You may **feel sick** (nausea) and **vomit at the start of treatment**. These effects are usually mild or moderate and only last for a short time. **Talk to your doctor** if they last for a long time or if you are worried about them.

Skin problems caused by the patch

- You may get redness and itching on the skin where the patch has been – these reactions are usually mild or moderate.
- The reactions normally go away after a few hours – once you remove the patch.
- **Talk to your doctor** if you have a skin reaction that lasts longer than a few days or is severe. Also do this if it spreads outside the area of skin that was covered by the patch.
- Avoid sunlight and solarium exposure on areas of skin showing any kind of skin reaction caused by the patch.
- To help avoid the skin reactions, you should put the patch on a different area of skin every day, and only use the same area again after 14 days.

Loss of consciousness can occur

Rotigotine Luye can cause loss of consciousness. This can happen especially when you start using Rotigotine Luye or when your dose is increased. Tell your doctor if you lose consciousness or feel dizzy.

Changes in behaviour and abnormal thinking

Tell your doctor if you notice any changes in behaviour, thinking or both, that are listed below. Your doctor will discuss ways of managing or reducing symptoms.

You may find it helpful to tell also a member of your family or carer that you are using this medicine and ask them to read this leaflet. This is so that your family or carer can tell you, or your doctor, if they are worried about any changes in your behaviour. Rotigotine Luye can cause unusual urges or cravings which you cannot resist such as the impulse, drive or temptation to do things that could harm yourself or others.

These may include:

- strong impulse to gamble too much – even if this seriously affects you or your family
- altered or increased sexual interest and behaviour which causes significant concern to you or others – for example, an increased sex drive
- uncontrolled shopping or spending too much
- binge eating (eating large amounts of food in a short period of time) or compulsive eating (eating more food than normal and more than is needed to satisfy your hunger).

Rotigotine Luye may cause other behaviours and abnormal thinking. These may include:

- abnormal thoughts about reality
- delusions and hallucinations (seeing or hearing things that are not real)
- confusion
- disorientation
- aggressive behaviour
- agitation
- delirium

Tell your doctor if you notice any changes in behaviour, thinking or both that are listed above. Your doctor will discuss ways of managing or reducing symptoms.

Allergic reactions

Contact your doctor if you notice signs of an allergic reaction – these can include swelling of the face, tongue or lips.

Side effects when using Rotigotine Luye for Restless Legs Syndrome

Tell your doctor or pharmacist if you notice any of the following side effects:

Very common: may affect more than 1 in 10 people

- headache
- feeling sick (nausea)
- feeling weak (fatigue)
- skin irritations under the patch such as redness and itching

Common: may affect up to 1 in 10 people

- itching
- feeling irritable
- allergic reaction
- increased sex drive
- high blood pressure
- vomiting, heartburn
- swelling of legs and feet
- feeling sleepy, falling asleep suddenly without warning, difficulty in sleeping, sleep problems, having unusual dreams
- unable to resist the impulse to perform an action that is harmful involving excessive gambling, repetitive meaningless actions, uncontrolled shopping or spending too much
- binge eating (eating large amount of food in a short period of time) or compulsive eating (eating more food than normal and more than needed to satisfy hunger)

Uncommon: may affect up to 1 in 100 people

- feeling agitated
- feeling dizzy when standing up because of a fall in blood pressure

Rare: may affect up to 1 in 1,000 people

- being aggressive
- disorientation

Not known: it is not known how often these happen

- craving large doses of medicines like Rotigotine Luye – more than needed for the illness. This is known as 'dopamine dysregulation syndrome' and can lead to use of too much Rotigotine Luye
- seeing or hearing things that are not real (hallucinations)
- nightmares
- paranoia
- confusion
- psychotic disorders
- delusion
- delirium
- feeling dizzy
- loss of consciousness, involuntary movements (dyskinesia)
- involuntary muscle spasms (convulsion)
- blurry vision
- visual disturbances such as seeing colours or lights
- vertigo (sensation of whirling motion)
- feeling of heartbeat (palpitation)
- abnormal heart rhythm
- low blood pressure
- hiccups
- constipation, dry mouth
- stomach discomfort and pain
- diarrhoea
- redness, increased sweating
- generalised itching, skin irritation
- generalised rash
- unable to achieve or maintain an erection
- weight loss, weight increase
- increased or abnormal liver function test results
- increased heart rate
- increased levels of creatine phosphokinase (CPK) (CPK is an enzyme found mainly in skeletal muscles)
- falling
- rhabdomyolysis (a rare severe muscle disorder which causes pain, tenderness and weakness of the muscles and may lead to kidney problems)

Talk to your doctor or pharmacist if you notice any of the side effects listed above.

Reporting of side effects

If you get any side effects, talk to your doctor or pharmacist. This includes any possible side effects not listed in this leaflet. You can also report side effects directly via the Yellow Card Scheme at www.mhra.gov.uk/yellowcard or search for MHRA Yellow Card in the Google Play or Apple App Store. By reporting side effects you can help provide more information on the safety of this medicine.

5. How to store Rotigotine Luye

Keep this medicine out of the sight and reach of children.

Do not use this medicine after the expiry date which is stated on the label and box.

This medicine does not require any special storage conditions.

What to do with the used and unused patches

- Used patches still contain the active substance 'rotigotine', which may be harmful to others. Fold the used patch with the sticky side inwards. Put the patch in the original sachet and then throw it away safely, out of the reach of children.
- Do not throw away any medicines via wastewater or household waste. Ask your pharmacist how to throw away medicines you no longer use. These measures will help protect the environment.

6. Contents of the pack and other information

What Rotigotine Luye contains

The active substance is rotigotine.

- 1 mg/24 h:
Each patch releases 1 mg of rotigotine per 24 hours. Each patch of 4.6 cm² contains 1.84 mg of rotigotine.
- 3 mg/24 h:
Each patch releases 3 mg of rotigotine per 24 hours. Each patch of 13.8 cm² contains 5.52 mg of rotigotine.

The other ingredients are:

- Backing film: pigmented polyethylene aluminium vapor coated polyester, orange printing ink
- Matrix layer, containing the active substance: tocopherol, paraffin, povidone K90, silicone adhesive
- Release liner: polyester film, fluorosilicone coated
- Cover sheet: polyester film, fluorosilicone coated

What Rotigotine Luye looks like and contents of the pack

Rotigotine Luye is a transdermal patch. It is a thin, rectangular patch with rounded corners. The outside is tan-coloured and is imprinted with

1 mg/24 h: "Rotigotine 1 mg/24 h"

3 mg/24 h: "Rotigotine 3 mg/24 h".

Rotigotine Luye is available in the following pack-sizes:

Boxes containing 7, 14, 28, 30 or 84 (multipack containing 3 packs of 28) patches, which are individually sealed in sachets. Not all pack sizes may be marketed.

Marketing Authorisation Holder

Luye Pharma Ltd.

40 Occam Road

Guildford, GU2 7YG

UK

Manufacturer

Luye Pharma AG

Am Windfeld 35

83714 Miesbach

Germany

This leaflet was last revised in August 2024

ARTWORK DETAILS	
Customer	Luye Pharma Ltd.
Product Name	Rotigotine Luye 1 mg-3mg/24 h transdermal patch
Market	United Kingdom
Language/s	English
Job ref.:	n/a
Pharma Laetus	n/a
Manufacturer Code	XXXXXXXXXX
Our Ref	
Client Ref/ Word doc used:	
Issue	04
Date	17 July 2024

SPECIFICATION DETAILS	
Origination	21 March 2024 – (as Issue 01)
Dimensions	280 x 480mm
Border	10 mm
Pharmacode No.	n/a
Font details	Main title: Arial - Bold - 20 pt Section titles: Arial - Bold - 9.5 pt Sub-titles: Arial - Bold - 8.5 pt Body copy: Arial - 8.5 pt
Colours	Black - K