

Package leaflet: Information for the user

COMBIVENT[®] UDVs[®]

(ipratropium bromide/salbutamol sulfate)

Read all of this leaflet carefully before you start taking this medicine

- Keep this leaflet. You may need to read it again.
- If you have any further questions, ask your doctor, pharmacist or practice nurse.
- This medicine has been prescribed for you. Do not pass it on to others. It may harm them, even if their symptoms are the same as yours.
- If any of the side effects gets troublesome or serious, or if you notice any side effects not listed in this leaflet, please tell your doctor or pharmacist.

The name of your medicine is COMBIVENT UDVs, but it will be referred to as COMBIVENT or COMBIVENT UDVs throughout this leaflet.

In this leaflet:

1. What COMBIVENT UDVs is and what it is used for
2. Before you use COMBIVENT UDVs
3. How to use COMBIVENT UDVs
4. Possible side effects
5. How to store COMBIVENT UDVs
6. Further information

1. WHAT COMBIVENT UDVs IS AND WHAT IT IS USED FOR

COMBIVENT UDVs should be used with a device called a 'nebuliser'. This changes your medicine into a mist for you to breathe in. COMBIVENT contains two different medicines called:

- Ipratropium bromide and
- Salbutamol sulfate

Both belong to a group of medicines called bronchodilators. They are used to make breathing easier in an illness called 'chronic obstructive pulmonary disease' or COPD. They work by opening up your airways.

2. BEFORE YOU USE COMBIVENT UDVs

Do not use COMBIVENT if:

- You are allergic (hypersensitive) to ipratropium or salbutamol or any of the other ingredients in COMBIVENT. (Listed in section 6: Further information)
- You are allergic to similar medicines which contain atropine or medicines like atropine
- You have a heart problem called 'hypertrophic obstructive cardiomyopathy'. This is where the wall between the two sides of the heart gets bigger and blocks the blood flow
- You have a very fast heart beat (called 'tachyarrhythmia')
- You are pregnant, likely to get pregnant or are breast-feeding

Do not use if any of the above apply to you. If you are not sure, talk to your doctor or pharmacist before using COMBIVENT.

Take special care with COMBIVENT

A condition known as lactic acidosis has been reported in association with high therapeutic doses of salbutamol, mainly in patients being treated for an acute bronchospasm (see Section 3 and 4). Increase in lactate levels may lead to shortness of breath and hyperventilation even though there may be improvement in your wheezing. If you feel that your medicine is not working as well as usual and you need to use the nebuliser more than your doctor has recommended, immediately talk to a doctor.

Check with your doctor or pharmacist before using this medicine if:

- You have glaucoma, or have been told that you may develop it
- You have heart or circulation problems, or have had a recent heart attack
- You have diabetes
- You have an over-active thyroid gland
- You have problems passing water (urine)
- You are a man who has prostate problems
- You have cystic fibrosis
- You have ever had something called 'pheochromocytoma'. This is a rare tumour which is not malignant. Using your inhaler can make the symptoms of this worse

If you are not sure if any of these apply to you, talk to your doctor or pharmacist before using COMBIVENT.

Taking other medicines

Please tell your doctor or pharmacist if you are taking or have recently taken any other medicines, including medicines obtained without a prescription. This includes herbal medicines. This is because COMBIVENT can affect the way some other medicines work. Also some other medicines can affect the way COMBIVENT works.

In particular, tell your doctor or pharmacist if you are taking any of the following medicines:

- Steroid medicines such as prednisolone
- Water tablets (also called 'diuretics')
- Medicines for depression
- Medicines to help your breathing
- Medicines called 'anti-cholinergics'. These can be used to treat colic pain, Parkinson's Disease, problems passing water or lack of control of your bladder or bowels
- Medicines called 'beta blockers' such as propranolol. These can be used to treat heart problems, high blood pressure, anxiety or migraine
- Medicines called 'beta mimetics' such as fenoterol for breathing problems
- Digoxin - used for a fast heart beat or heart failure

If you are not sure if any of the above apply to you, talk to your doctor or pharmacist before using COMBIVENT.

Operations

Some gases used in operations (anaesthetic gases) may affect how your medicine works. If you are about to have surgery, make sure you mention that you are taking COMBIVENT to the doctor, dentist or anaesthetist.

Tests

If you have to provide an urine sample as part of a routine sport drug test, tell the person giving the test that you are taking this medicine. This is because COMBIVENT contains salbutamol and this may lead to a positive result.

Pregnancy and breast-feeding

Do not use COMBIVENT if you are pregnant, likely to get pregnant or are breast-feeding.

Driving and using machines

You may feel dizzy, or have difficulty in focusing, or blurred vision whilst taking COMBIVENT.

If this happens do not drive or use tools or machines.

3. HOW TO USE COMBIVENT UDVs

Always use COMBIVENT exactly as your doctor has told you. You should check with your doctor or pharmacist if you are not sure. Follow these instructions to get the best results.

If anything is unclear after reading this leaflet, ask your doctor, pharmacist or practice nurse.

How many dose units

The usual dose is the contents of 1 single dose unit, three or four times a day for: Adults (including the elderly) and children over 12 years.

COMBIVENT is not recommended for children under 12 years.

Do not swallow or give this medicine by injection.

Do not use more than your doctor has told you

See your doctor straight away if:

- You feel that your medicine is not working as well as usual
- You need to use the nebuliser more than your doctor has recommended

Your doctor may need to check how well your medicine is working.

In some cases your doctor may need to change your medicine.

How to use your nebuliser

Read through numbers 1 to 6 first, before starting to use your nebuliser.

- Get your nebuliser ready by following the manufacturer's instructions. Ask your doctor if you are not sure how to use it.

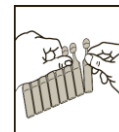

2. • Open the pouch and remove the strip of unit dose vials
- Carefully separate a new dose unit from the strip
- Do not use if it is already open or if the liquid inside is discoloured

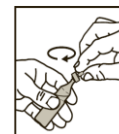

3. • Twist off the top
- Always hold it upright while you do this



4.
 - Squeeze all the contents of the dose unit into the nebuliser chamber
 - Your doctor will tell you if you need to use a different amount
 - If your doctor has told you that your medicine needs to be diluted, you will be given 'sterile sodium chloride 0.9%' solution. Your doctor will tell you how to do this

5. Use your nebuliser as directed by your doctor.
6.
 - After you have finished, dispose of any leftover medicine carefully
 - Follow the manufacturer's instructions on how to clean your nebuliser
 - It is important to keep your nebuliser clean

If any of the liquid or mist accidentally gets into your eyes you may get painful, stinging or red eyes, dilated pupils, blurred vision, see colours or lights. If this happens, talk to your doctor for advice. If you get problems with your eyes at any other time, talk to your doctor for advice.

If you use more COMBIVENT than you should

If you use more of this medicine than you should, talk to a doctor or go to a hospital straight away.

If you forget to take COMBIVENT

- If you forget a dose, take it as soon as you remember it
- However, if it is time for the next dose, skip the missed dose
- Do not take a double dose to make up for a forgotten dose

If you have any further questions, ask your doctor or pharmacist.

4. POSSIBLE SIDE EFFECTS

Like all medicines, COMBIVENT can cause side effects, although not everybody gets them.

Tell your doctor straight away if you notice any of the following serious side effects – you may need urgent medical treatment:

- If after taking COMBIVENT you are wheezy or have other difficulties in breathing, do not take any more (unless you have been told to by your doctor)
- Allergic reactions - the signs may include skin rash, itching and nettle rash. In severe cases the signs include swelling of your tongue, lips and face, sudden difficulties in breathing and a fall in your blood pressure that may cause dizziness.

See your doctor straight away if you have any of these side effects.

The following side effect can also happen but the frequency of this is not known:

- A condition known as lactic acidosis which may cause stomach pain, hyperventilation, shortness of breath even though there may be improvement in your wheezing, cold feet and hands, irregular heartbeat or thirst.

The side effects described below have been experienced by people taking COMBIVENT.

Uncommon (affects less than 1 in 100 people)

- Feeling nervous, shaky or dizzy
- Dry mouth
- Cough, headache
- Feeling sick (nausea)
- Throat irritation
- Increase in blood pressure
- Increased heart rate or uneven heart beats (palpitations)
- Voice problems ('dysphonia')
- Skin reactions.

Rare (affects less than 1 in 1,000 people)

- Irregular heart beat
- Regular but abnormally fast heart rate (supraventricular tachycardia)
- Chest pain (due to heart problems such as angina). Tell your doctor or pharmacist if this occurs but do not stop taking this medicine unless told to do so
- Blurred vision, dilated pupils, glaucoma, painful, stinging, or red eyes, swelling of the eyes, see colours or lights
- Increased sweating
- Unexpected tightening of the chest immediately after inhaling the medicine
- Dry throat, swelling of the throat

- Difficulty in breathing or speaking due to a brief spasm of your vocal muscles
- Diarrhoea, constipation, being sick (vomiting) or other problems with your digestive system
- Inflammation of the mouth
- Muscle cramps, muscle weakness and pain
- Difficulty in passing water (urine)
- Feeling weak
- Fall in blood pressure
- Mood changes.

You may also get unusually low levels of potassium in your blood (called 'hypokalemia').

If this happens, your doctor will keep checking your potassium levels.

If any of the liquid or mist accidentally gets into your eyes you may get painful, stinging or red eyes, dilated pupils, blurred vision, see colours or lights. If this happens, talk to your doctor for advice. If you get problems with your eyes at any other time, talk to your doctor for advice.

Reporting of side effects

If you get any side effects, talk to your doctor or pharmacist. This includes any possible side effects not listed in this leaflet. You can also report side effects directly via the Yellow Card Scheme at: www.mhra.gov.uk/yellowcard or search for MHRA Yellow Card in the **Google Play** or **Apple App Store**. By reporting side effects, you can help provide more information on the safety of this medicine.

5. HOW TO STORE COMBIVENT UDV'S

Keep out of the sight and reach of children.

Do not store above 25°C.

Do not refrigerate or freeze.

Keep vials in the outer carton in order to protect from light.

Do not use if the solution is discoloured or cloudy.

Do not use this medicine after the expiry date which is stated on the carton and vial labels after 'Exp'. The expiry date refers to the last day of that month.

If the medicine shows any other signs of deterioration, seek the advice of your pharmacist.

Remember if your doctor tells you to stop taking this medicine, return any unused medicine to your pharmacist for safe disposal.

Only keep this medicine if your doctor tells you to.

Medicines should not be disposed of via wastewater or household waste. Ask your pharmacist how to dispose of medicines no longer required. These measures will help to protect the environment.

6. FURTHER INFORMATION

What COMBIVENT UDV'S contain

The active ingredients in the COMBIVENT UDV'S are ipratropium bromide and salbutamol sulfate.

COMBIVENT UDV'S contain a nebuliser solution.

Each single dose unit contains 500 micrograms ipratropium bromide and 2.5mg salbutamol (as sulphate) in 2.5ml isotonic preservative free solution.

The other ingredients are: sodium chloride, hydrochloric acid and purified water.

What COMBIVENT UDV'S look like and contents of the pack

COMBIVENT UDV'S comes with a nebuliser. This changes your medicine into a mist for you to breathe in. COMBIVENT UDV'S are available in 2.5ml unit dose vials in strips of 10 units inside a foil pouch. Each pack contains 60 units (10 x 6 pouches).

Manufactured by: Laboratoire Unither, Espace Industriel Nord, 151, Rue Andre Durouchez - CS 28028, 80084 Amiens Cedex 2, France.

Procured from within the EU and repackaged by the Product Licence holder:

B&S Healthcare, Unit 4, Bradfield Road, Ruislip, Middlesex, HA4 0NU, UK.

COMBIVENT® UDV'S®; PL 18799/2199

Leaflet date: 28.05.2019

POM

Combivent and UDV'S are registered trademarks of Boehringer Ingelheim Pharma GmbH & Co. KG.

Blind or partially sighted? Is this leaflet hard to see or read? Call 0208 515 3763 to obtain the leaflet in a format suitable for you.